

Compact CA

Häggglunds hydraulic motors

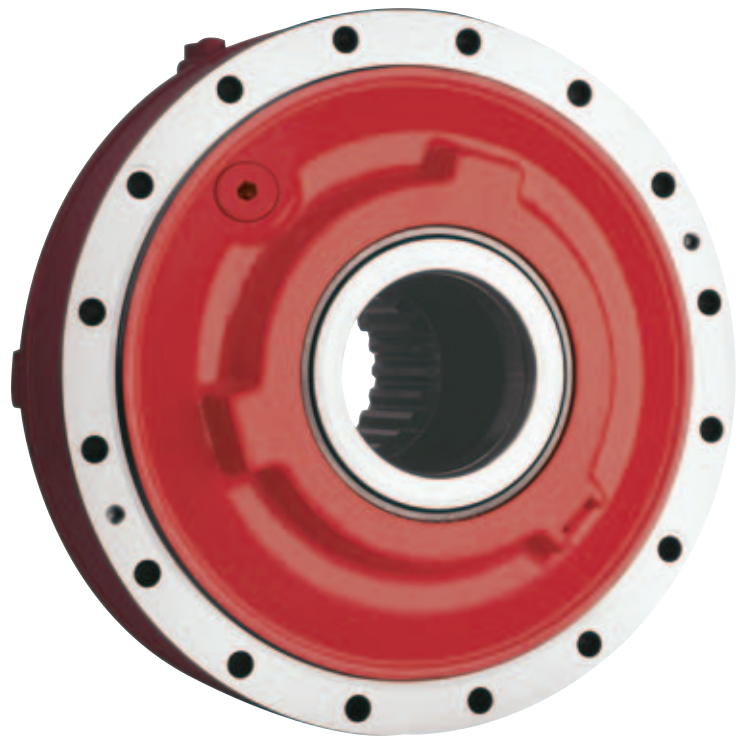

With its small envelope size and light weight, Häggglunds Compact CA motor has an unbeatable power to weight ratio.



Compact CA motor

The optimal solution when size and weight is an issue

Dimensions, motors with splines

Motor type	A (mm)	B (mm)	C (mm)	D (mm)	E (mm)	Weight (kg)	Main Conn.	Drain Conn.
CA50	464	312.5	390	46.5	N120x5x30x22x9H	175	SAE 1 1/4"	BSP 3/4"
CA 70	495	312.5	435	46.5	N120x5x30x22x9H	205	SAE 1 1/4"	BSP 3/4"
CA100	560	399.5	470	135.5	N140x5x30x26x9H	265	SAE 1 1/4"	BSP 3/4"
CA 140	600	399.5	510	135	N140x5x30x26x9H	305	SAE 1 1/4"	BSP 3/4"
CA 210	600	501	510	156.5	N150x5x30x28x9H	395	SAE 1 1/4"	BSP 3/4"

Dimensions, motors with shrink disc coupling

Motor type	A (mm)	B (mm)	C (mm)	D (mm)	DW (mm)	Weight (kg)	Main Conn.	Drain Conn.
CA50	464	404.5	390	138	120	203	SAE 1 1/4"	BSP 3/4"
CA 70	495	404.5	435	138	120	232	SAE 1 1/4"	BSP 3/4"
CA100	560	505	470	241	140	310	SAE 1 1/4"	BSP 3/4"
CA 140	600	505	510	241	140	347	SAE 1 1/4"	BSP 3/4"
CA 210	600	644.5	510	300	160	456	SAE 1 1/4"	BSP 3/4"

Motor data

Motor-type*	Full displacement					Displacement shift				
	Displacement (cm ³ /rev)	Specific torque (Nm/bar)	Rated speed ** (rev/min)	Max speed (rev/min)	Max pressure (bar)***	Displacement (cm ³ rev)	Specific torque (Nm/bar)	Rated speed ** (rev/min)	Max speed (rev/min)	Ratio
CA 50 20	1256	20	400	400	350					
CA 50 25	1570	25	350	400	350					
CA 50 32	2010	32	280	400	350					
CA 50 40	2512	40	230	350	350					
CA 50	3140	50	200	280	350	1570	25	200	280	1:2
CA 70 40	2512	40	270	400	350					
CA 70 50	3140	50	225	320	350	1570	25	225	320	1:2
CA 70 60	3771	60	195	275	350	1886	30	195	275	1:2
CA 70	4400	70	180	240	350	2200	35	180	240	1:2
CA 100 40	2512	40	390	400	350					
CA 100 50	3140	50	320	400	350					
CA 100 64	4020	64	260	390	350					
CA 100 80	5024	80	220	310	350	2512	40	220	280	1:2
CA 100	6280	100	190	270	350	3140	50	190	270	1:2
CA 140 80	5024	80	245	340	350					
CA 140 100	6280	100	205	275	350	3140	50	205	275	1:2
CA 140 120	7543	120	180	245	350	3771	60	180	245	1:2
CA 140	8800	140	170	220	350	4400	70	170	220	1:2
CA 210 160	10051	160	105	150	350	5026	80	105	150	1:2
CA 210 180	11314	180	100	135	350	5675	90	100	135	1:2
CA 210	13200	210	85	115	350	6600	105	85	115	1:2

CA 50, CA 70

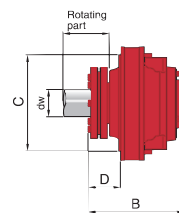
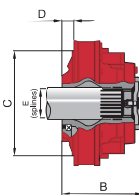
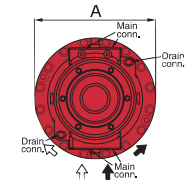

CA 100, CA 140

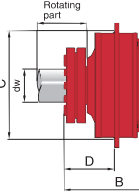
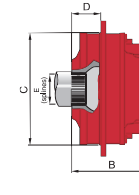
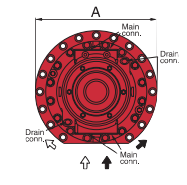

*) All motor types can be tandem mounted.

**) Special considerations regarding charge pressure, cooling and choice of hydraulic system for speeds above rated.

***) The motors are designed according to DNV-rules. Test pressure 420 bar/6000 psi. Peak/ transient pressure 420 bar/6000 psi maximum, allowed to occur 10 000 times.